

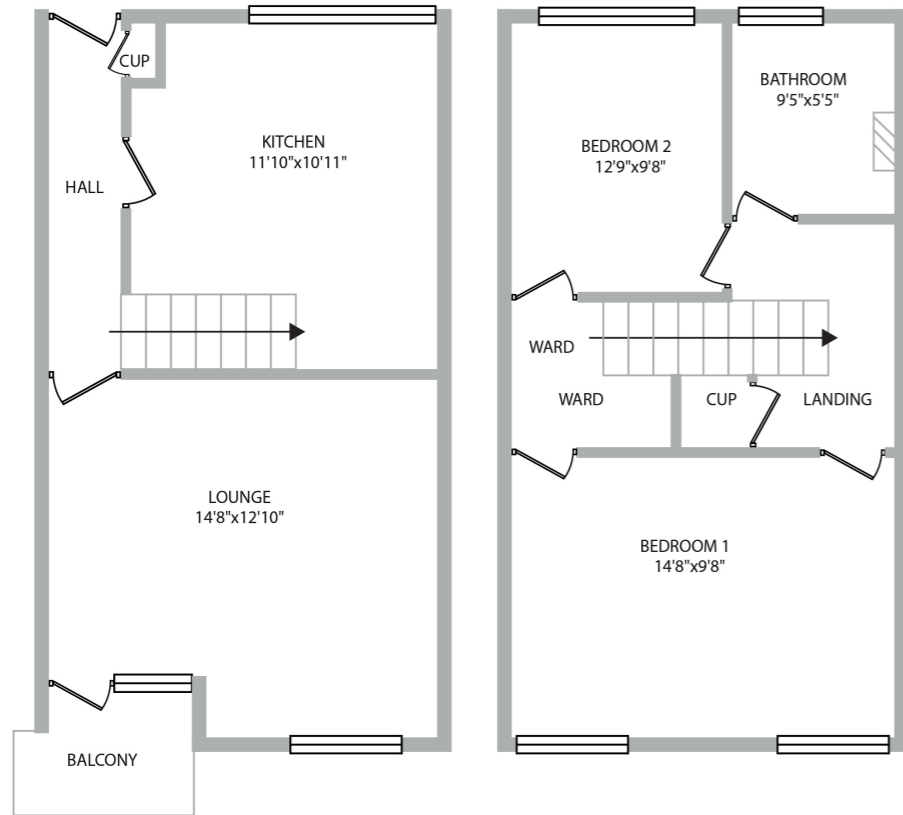

www.caledoniaproperty.co.uk

## Attlee Avenue Linnvale G81 2SD



Scotland's quality online estate agent with a High Street presence.

Your local High Street office: 2 Dumbarton Rd, Clydebank G81 1TU . T. 0141 952 2284 E. clydebank@caledoniaproperty.co.uk

Please Note - Whilst this brochure has been prepared with care, it is not a report on the condition of the property. Its terms are not warranted and do not constitute and offer to sell. All area and room measurements are approximate only. No services, equipment or central heating have been tested and no warranty is given or implied that these are in working order or that they are connected to supply. Buyers are advised to see their own verification in this regard.



Attlee Avenue Linnvale G81 2SD



www.caledoniaproperty.co.uk







Attlee Avenue  
Linnvale G81 2SD



Rarely available, very well proportioned second floor maisonette flat situated within a popular and convenient area. Accommodation comprises: Spacious lounge with balcony off, good sized fitted kitchen with integrated stainless steel gas hob, electric oven and extractor hood. There are two double bedrooms with storage and a wet wall panelled bathroom with over bath shower. The subjects benefit from gas central heating, double glazing, a communal drying room located off the communal landing, and shared off street parking. Ideal first time buy / buy to let flat and early internal viewing is recommended.

Clydebank offers a whole host of excellent services including the popular Clyde Shopping Centre and Great Western Retail Park which is located close by. Sport and recreation facilities are readily available as are first class primary and secondary schools. Frequent train connections from both Clydebank and Singer railway stations mean Glasgow City Centre is less than 20 minutes away. There are also numerous bus services for commuters. The A82, Great Western Road and Erskine Bridge can be easily accessed by road.

Offers Over £59,995

Viewing:

by appointment with  
Caledonia Property

0141 952 2284

EPC: Band C  
Ref No: C1329

