

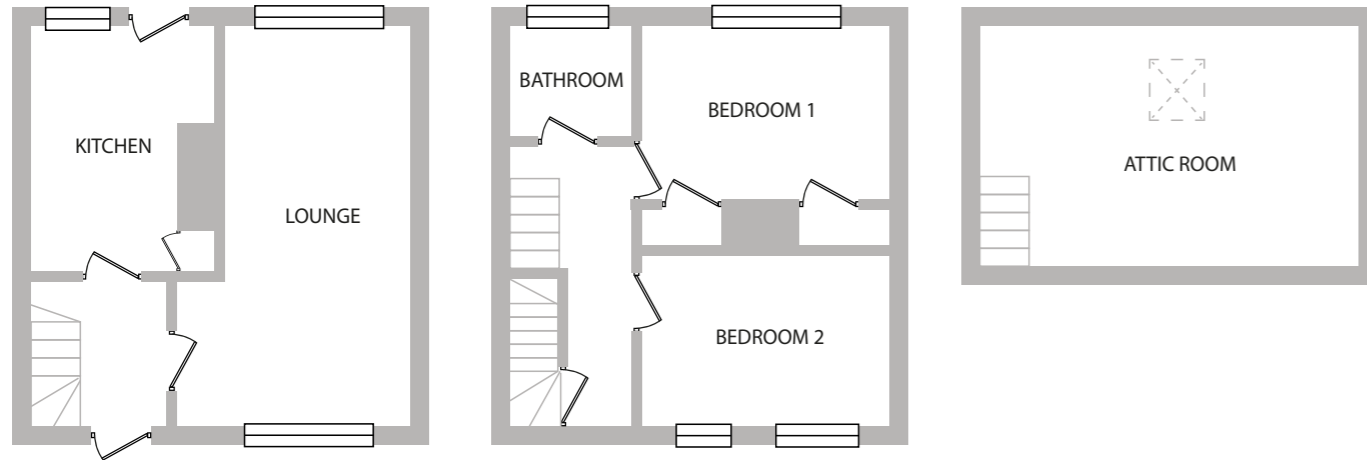

www.caledoniaproperty.co.uk

6 Waverley Terrace **Dumbarton G82 5DW**



Scotland's quality online estate agent with a High Street presence.

Your local High Street office: 130 High Street, Dumbarton G82 1PQ. **T.** 0333 241 3333 **E.** dumbarton@caledoniaproperty.co.uk

Please Note - Whilst this brochure has been prepared with care, it is not a report on the condition of the property. Its terms are not warranted and do not constitute and offer to sell. All area and room measurements are approximate only. No services, equipment or central heating have been tested and no warranty is given or implied that these are in working order or that they are connected to supply. Buyers are advised to see their own verification in this regard.



6 Waverley Terrace **Dumbarton G82 5DW**



www.caledoniaproperty.co.uk





6 Waverley Terrace Dumbarton G82 5DW



Viewing:
by appointment with
Caledonia Property

0333 241 3333

EPC: Band C
Ref No: DG1375

A delightful two bedroom mid terraced villa with the added advantage of multiple vehicle off street driveway and rear gardens with large outhouse.

The property itself has a dry dash exterior with concrete tiled roof, double glazed windows whilst warmth is provided by gas central heating.

The garden to front is predominantly driveway with garden shed; steps down to lawn section leading to front door. The rear gardens again with lawn section and large patio area; rear gardens give access to a large timber outhouse/shed/workshop which has power and lighting. Garden is bound by hedging.

Internally the accommodation consists reception hall with staircase to upper, spacious lounge/dining room with feature fireplace, modern fitted kitchen with generous floor standing and wall mounted units, space and plumbing for appliances. Upstairs to shower room comprising low flush wc, pedestal wash hand basin and shower cubicle and two double bedrooms. Please note the attic has been floored with power and lighting.

The property has been decorated in modern neutral shades complemented by wood effect laminate flooring and carpeting.

