

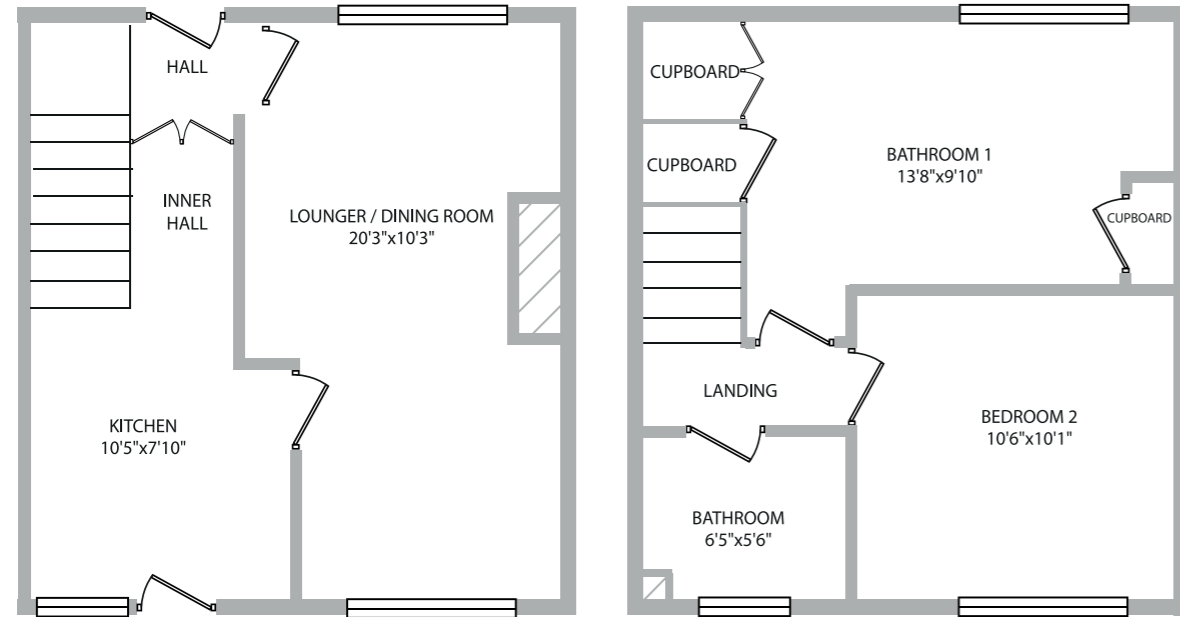

www.caledoniaproperty.co.uk

Ashtree Court Old Kilpatrick



Scotland's quality online estate agent with a High Street presence.

Your local High Street office: 2 Dumbarton Rd, Clydebank G81 1TU . T. 0333 241 3333 E. clydebank@caledoniaproperty.co.uk

Please Note - Whilst this brochure has been prepared with care, it is not a report on the condition of the property. Its terms are not warranted and do not constitute and offer to sell. All area and room measurements are approximate only. No services, equipment or central heating have been tested and no warranty is given or implied that these are in working order or that they are connected to supply. Buyers are advised to see their own verification in this regard.



Ashtree Court Old Kilpatrick



www.caledoniaproperty.co.uk



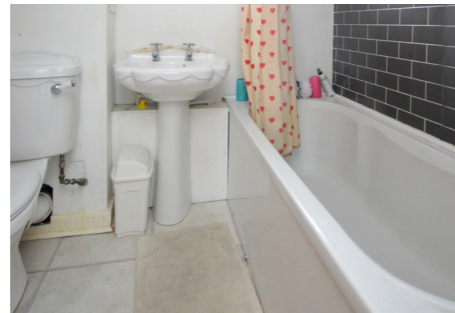

Ashtree Court Old Kilpatrick



Offers Over £87,995
Viewing:
by appointment with
Caledonia Property

0333 241 3333

EPC: Band E
Ref No: C1312

Rarely available, well proportioned upper floor maisonette flat situated in a refurbished building and located within a sought after area. Accommodation comprises: Spacious lounge with balcony off, modern fitted kitchen with appliances, two double bedrooms with built-in wardrobes and bathroom with over bath shower. The subjects benefit from electric heating, double glazing, allocated private storage area on ground floor, communal parking area and well maintained lawned garden grounds. Early internal viewing is highly recommended.

The village of Old Kilpatrick enjoys a fantastic setting on the edge of the River Clyde with popular walks along the Forth and Clyde Canal. It offers a variety of local amenities including shops and bars and is very well connected to Glasgow via regular rail and bus links. Further excellent shopping facilities can be easily accessed in nearby Dumbarton and Clydebank. Main road connections are the A82 which puts Loch Lomond and the West of Scotland within easy reach. Erskine Bridge is only moments away. The popular Gavinburn Primary School is located within Old Kilpatrick.

